

## FEATURES

- Solid bar-stock drilled design
- 3 different shank styles
- Flanged process connection

## APPLICATIONS

- Air & flue gas
- Tanks & vessels
- Oil & Gas applications
- Corrosive environments
- Power & Steel industries
- HVAC, Air filters & utilities
- On-shore/Off-shore application

## Stepped Shank



## STANDARD SPECIFICATIONS

Shank form	: Stepped
Flange material	: AISI 316 SS
Well material	: AISI 316 SS
Instrument connection	: ½" NPT (F)
Bore diameter	: 7 mm
Lag extension	: 50 mm
Root diameter	: By order
Tip diameter	: By order
Immersion length	: By order
Tip thickness	: 5 mm
Process connection	: Flange as per ANSI B16.5, EN 1092-1
Flange facing type	: Raised face

## DIMENSIONAL DRAWING

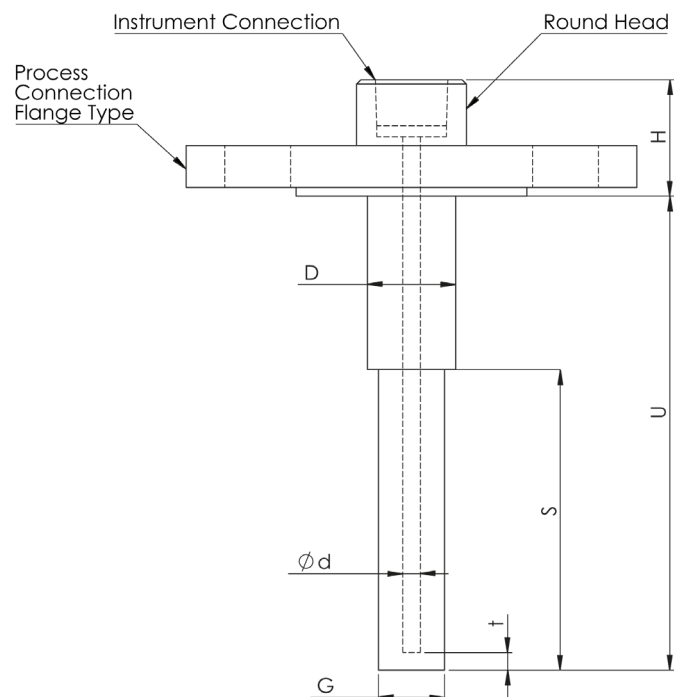

## ORDERING CODES

### 1. SHANK FORM

P	Stepped	P
---	---------	---

### 2. FLANGE MATERIAL

MB	Carbon Steel / ASTM A105	MG	AISI 316L SS	MB
MC	AISI 304 SS	MV	Titanium	
MF	AISI 316 SS			
MM	Monel			
MO	Hastelloy C-276			
MR	Inconel 625			
MI	AISI 321 SS			

### 3. WELL MATERIAL

MB	Carbon Steel / ASTM A105	MG	AISI 316L SS	MB
MC	AISI 304SS	MV	Titanium	
MF	AISI 316 SS			
MM	Monel			
MO	Hastelloy C-276			
MR	Inconel 625			
MI	AISI 321 SS			

### 4. INSTRUMENT CONNECTION

02N	1/4" NPT (F)	04N	1/2" NPT (F)	02N
05N	3/4" NPT (F)	02B	1/4" BSP (F)	
04B	1/2" BSP (F)	05B	3/4" BSP (F)	
04M	M20 x 1.5 mm (F)			

### 5. PROCESS CONNECTION

XXX	Refer Flange Table for the codes	XXX
-----	----------------------------------	-----

### 6. FLANGE FACING

FF	Flat Face	FF
RJ	Ring-Type Joint	
RF	Raised Face	

### 7. LAG EXTENSION ("T")

XXX	35 mm up to 250 mm	50
-----	--------------------	----

### 8. CONNECTION LENGTH ("H")

XXX	Mention in 'mm' (minimum 30mm)	30
-----	--------------------------------	----

### 9. ROOT DIAMETER ("D")

XX.X	Mention in 'mm'	25
------	-----------------	----

### 10. TIP DIAMETER ("G")

XX.X	Mention in 'mm'	18
------	-----------------	----

### 11. BORE DIAMETER ("d")

NN	6.35 mm (1/4")	OO	10 mm
UU	7.0 mm	YY	11 mm
VV	9.0 mm	LL	12 mm
WW	9.6 mm	ZZ	13 mm

### 12. IMMERSION LENGTH ("U")

XXXX	50 mm up to 1000 mm	150
------	---------------------	-----

### 13. STEP / TAPER LENGTH ("S")

XXX	Mention in 'mm'	50
-----	-----------------	----

### 14. TIP THICKNESS ("t")

QQ	5 mm	QQ
NN	6.35 mm (1/4")	
OO	10 mm	

### 15. CONSTRUCTION

FA	Flange & well full penetration welded	FA
FB	Flange & well thread jointed and seal Welded	
FC	Flange & well seal welded	

### 16. COATING ON WELL & FLANGE

ME	PTFE	ME
----	------	----

## NOTES

- Other diameters, connections are available, please contact factory for details.
- Please refer "Technical Reference" for the proper selection of connections according to Head size and Outer diameter of the well.

## ORDERING CODES

### 17. OTHER OPTIONS

<b>XI</b>	Plug & chain in SS	
<b>XK</b>	Electro polishing	
<b>XL</b>	Marking by laser	
<b>XM</b>	Marking by engraving	<b>XM</b>
<b>TC</b>	Material test certificate	
<b>TD</b>	Dye penetration test	
<b>TF</b>	PMI test	
<b>TH</b>	Hydro test certificate	
<b>TN</b>	NACE standards	
<b>TW</b>	WFC as per PTC 19.3TW:2010	

Ordering Example : W91-P-MB-MB-02N-XXX-FF-50-30-25-18-UU-150-50-QQ-FA-ME-XM

## Flange Table

### ANSI B 16.5

Code	Size	Rating	Code	Size	Rating	Code	Size	Rating
A01	½"	150#	A02	½"	300#	A03	½"	600#
A04	½"	900#	A05	½"	1500#	A06	½"	2500#
A07	¾"	150#	A08	¾"	300#	A09	¾"	600#
A10	¾"	900#	A11	¾"	1500#	A12	¾"	2500#
A13	1"	150#	A14	1"	300#	A15	1"	600#
A16	1"	900#	A17	1"	1500#	A18	1"	2500#
A19	1¼"	150#	A20	1¼"	300#	A21	1¼"	600#
A22	1¼"	900#	A23	1¼"	1500#	A24	1¼"	2500#
A25	1½"	150#	A26	1½"	300#	A27	1½"	600#
A28	1½"	900#	A29	1½"	1500#	A30	1½"	2500#
A31	2"	150#	A32	2"	300#	A33	2"	600#
A34	2"	900#	A35	2"	1500#	A36	2"	2500#
A37	2½"	150#	A38	2½"	300#	A39	2½"	600#
A40	2½"	900#	A41	2½"	1500#	A42	2½"	2500#
A43	3"	150#	A44	3"	300#	A45	3"	600#
A46	3"	900#	A47	3"	1500#	A48	3"	2500#
A49	4"	150#	A50	4"	300#	A51	4"	600#
A52	4"	900#	A53	4"	1500#	A54	4"	2500#

## NOTES

1. Other diameters, connections are available, please contact factory for details.
2. Please refer "Technical Reference" for the proper selection of connections according to Head size and Outer diameter of the well.

03/03