

## FEATURES

- Forged chambers
- Rigid construction
- Laser welded diaphragm
- Optional exotic materials

## APPLICATIONS

- Separation systems
- Isolation applications
- Viscous & corrosive media
- High-pressure applications
- High vibration application

## Direct Coupled



### STANDARD SPECIFICATIONS

Range type	: -1...400 bar
Top chamber material	: AISI 316 SS
Diaphragm	: AISI 316 SS
Gaskets	: PTFE
Bottom chamber material	: AISI 316 SS
Instrument connection	: 1/2" NPT (F) / 1/2" BSP (F)
Sealing fluid	: Silicon
Process connection	: 1/2" NPT (M) / 1/2" BSP (M)
Assembly	: Direct
Weight	: ~1540 g

### DIMENSIONAL DRAWING

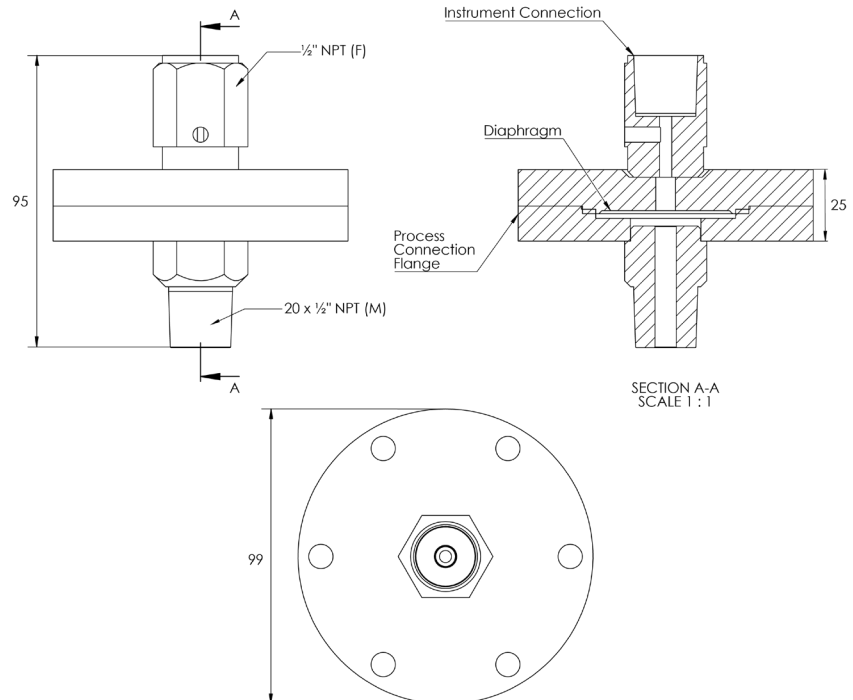

All dimensions are in mm.

## ORDERING CODES

### 1. RANGE TYPE

Z01	-1...400 bar	Z01
-----	--------------	-----

### 2. TOP CHAMBER MATERIAL

MC	AISI 304 SS	MF	AISI 316 SS	MF
MG	AISI 316L SS	MM	Monel	
MO	Hastelloy C-276	MP	PVC	

### 3. DIAPHRAGM MATERIAL

MG	AISI 316L SS	MM	Monel	MG
MF	AISI 316 SS	MQ	Inconel 600	
MO	Hastelloy C-276	MW	Tantalum	
MV	Titanium	MP	PVC	
MS	Silver coated			

### 4. GASKETS

ME	PTFE	ML	Metal	ME
----	------	----	-------	----

### 5. BOTTOM CHAMBER MATERIAL

MC	AISI 304 SS	MF	AISI 316 SS	MF
MG	AISI 316L SS	MM	Monel	
MO	Hastelloy C-276	MV	Titanium	
MW	Tantalum	MP	PVC <sup>1</sup>	
ME	PTFE	MK	PVDF <sup>1</sup>	
MJ	Polypropylene <sup>1</sup>			

### 6. INSTRUMENT CONNECTION

03B	3/8" BSP (F)	04N	1/2" NPT (F)	04N
02B	1/4" BSP (F)	04B	1/2" BSP (F)	
02N	1/4" NPT (F)			

### 7. SEALING FLUID

OA	Silicon	OA
OG	Glycerine	

### 8. PROCESS CONNECTION

12B	1/4" BSP (M)	13B	3/8" BSP (M)	
14B	1/2" BSP (M)	15B	3/4" BSP (M)	
12N	1/4" NPT (M)	14N	1/2" NPT (M)	14N
15N	3/4" NPT (M)	14M	M20 x 1.5 (M)	
17M	M33 x 2.0 (M)	02N	1/4" NPT (F)	
04N	1/2" NPT (F)	05N	3/4" NPT (F)	
02B	1/4" BSP (F)	04B	1/2" BSP (F)	
05B	3/4" BSP (F)			

### 9. PROTECTION ON WETTED PARTS

PL	PTFE lining on bottom chamber <sup>4,5</sup>	PL
PB	PTFE protection for diaphragm	
PC	PTFE coating on diaphragm	

### 10. ASSEMBLY

DR	Direct	DR
RE	Remote	

### 11. CAPILLARY

MC	AISI 304 SS	MF	AISI 316 SS	MF
----	-------------	----	-------------	----

### 12. ARMOUR

MC	AISI 304 SS	MF	AISI 316 SS	MF
MP	PVC (Ambient max. 60°C)			

### 13. REMOTE MOUNTING LENGTH

XXXX	1000 mm up to 6000 mm	6000
------	-----------------------	------

### 14. OTHER OPTIONS

TC	Material test certificate	TC
TN	NACE standards	

Ordering Example : US-Z01-MF-MG-ME-MF-04N-OA-14N-PL-DR-MF-MF-6000-TC

## NOTES

1. Pressure rating up to 10 bar. Consult factory for details.
2. Other sealing liquids are available, contact factory for further details.
3. All metal diaphragms are laser welded to the top chamber.
4. PTFE lining to be chosen on parallel threads.