

FEATURES

- Flush fitment in pipeline
- Laser welded flush diaphragm
- Optional flushing ring
- Optional exotic materials

APPLICATIONS

- Slurry applications
- Transmitter refurbishment

Pan-cake



STANDARD SPECIFICATIONS

Range type	: -1...250 bar
Wafer material	: AISI 316 SS
Diaphragm	: AISI 316 SS
Instrument connection	: 1/4" NPT (M)
Sealing fluid	: Silicon
Process connection	: RF size as per ANSI B16.5 / EN 1092-1 / JIS B 2210
Assembly	: Remote
Capillary	: AISI 304 SS
Armour	: AISI 304 SS
Remote mounting length	: 2000 mm

DIMENSIONAL DRAWING

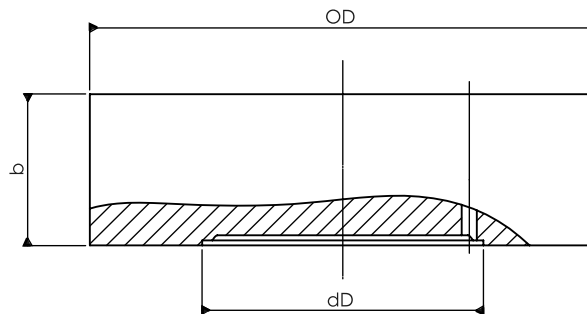

Size	Rating	OD	dD	b
1"	cl. 150-2500	50.8	23.5	24.0
1.5"	cl. 150-600	73.0	44.0	24.0
	cl. 900-2500	73.0	32.0	24.0
2"	cl. 150-600	92.1	57.0	24.0
	cl. 900-2500	92.1	44.0	24.0
3"	cl. 150-2500	127.0	81.0	24.0
4"	cl. 150-2500	157.2	81.0	24.0

All dimensions are in mm.

ORDERING CODES

1. RANGE TYPE

Z42	-1...250 bar	Z42
-----	--------------	-----

2. CHAMBER MATERIAL

MF	AISI 316 SS	MF
MG	AISI 316L SS	
MM	Monel	
MO	Hastelloy C-276	

3. DIAPHRAGM MATERIAL

MG	AISI 316L SS	MG
MF	AISI 316 SS	
MM	Monel	
MO	Hastelloy C-276	
MV	Titanium	
MW	Tantalum	
MX	Nickel	

4. INSTRUMENT CONNECTION

12B	1/4" BSP (M)	
12N	1/4" NPT (M)	12N
14B	1/2" BSP (M)	
14N	1/2" NPT (M)	

5. SEALING FLUID

OA	Silicon	OA
----	---------	----

6. PROCESS CONNECTION

XXX	Refer Flange Table for the codes	XXX
-----	----------------------------------	-----

7. PROTECTION ON WETTED PARTS

PC	PTFE coating on diaphragm	PC
PB	PTFE protection for diaphragm	

8. ASSEMBLY

RE	Remote	RE
----	--------	----

9. CAPILLARY

MC	AISI 304 SS	MC
MF	AISI 316 SS	

10. ARMOUR

MC	AISI 304 SS	MC
MF	AISI 316 SS	
MP	PVC (Ambient max. 60°C)	

11. REMOTE MOUNTING LENGTH

XXXX	2000 mm up to 6000 mm	2000
------	-----------------------	------

12. OTHER OPTIONS

TC	Material test certificate	TC
TN	NACE standards	

Ordering Example : BRC-Z42-MF-MG-12N-OA-XXX-PC-RE-MC-MC-2000-TC

.....

.....

.....

.....

.....

.....

.....

.....

.....

.....

Flange Table

ANSI B 16.5

Code	Size	Rating	Code	Size	Rating	Code	Size	Rating
A01	½"	150#	A02	½"	300#	A03	½"	600#
A04	½"	900#	A05	½"	1500#	A06	½"	2500#
A07	¾"	150#	A08	¾"	300#	A09	¾"	600#
A10	¾"	900#	A11	¾"	1500#	A12	¾"	2500#
A13	1"	150#	A14	1"	300#	A15	1"	600#
A16	1"	900#	A17	1"	1500#	A18	1"	2500#
A19	1¼"	150#	A20	1¼"	300#	A21	1¼"	600#
A22	1¼"	900#	A23	1¼"	1500#	A24	1¼"	2500#
A25	1½"	150#	A26	1½"	300#	A27	1½"	600#
A28	1½"	900#	A29	1½"	1500#	A30	1½"	2500#
A31	2"	150#	A32	2"	300#	A33	2"	600#
A34	2"	900#	A35	2"	1500#	A36	2"	2500#
A37	2½"	150#	A38	2½"	300#	A39	2½"	600#
A40	2½"	900#	A41	2½"	1500#	A42	2½"	2500#
A43	3"	150#	A44	3"	300#	A45	3"	600#
A46	3"	900#	A47	3"	1500#	A48	3"	2500#
A49	4"	150#	A50	4"	300#	A51	4"	600#
A52	4"	900#	A53	4"	1500#	A54	4"	2500#