

FEATURES

- Solid bar-stock drilled design
- 3 different shank styles
- Flanged process connection

APPLICATIONS

- Air & flue gas
- Tanks & vessels
- Oil & Gas applications
- Corrosive environments
- Power & Steel industries
- HVAC, Air filters & utilities
- On-shore/Off-shore application

Tapered Shank



STANDARD SPECIFICATIONS

| | |
|-----------------------|---------------------------------------|
| Shank form | : Tapered |
| Flange material | : AISI 316 SS |
| Well material | : AISI 316 SS |
| Instrument connection | : ½" NPT (F) |
| Bore diameter | : 7 mm |
| Lag extension | : 50 mm |
| Root diameter | : By order |
| Tip diameter | : By order |
| Immersion length | : By order |
| Step / Taper Length | : By order |
| Tip thickness | : 5 mm |
| Process connection | : Flange as per ANSI B16.5, EN 1092-1 |
| Flange facing type | : Raised face |

DIMENSIONAL DRAWING

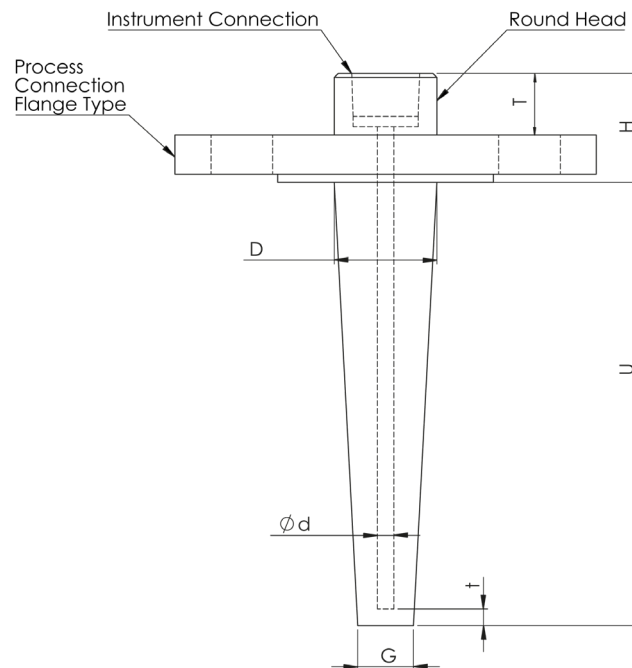

ORDERING CODES

1. SHANK FORM

| | | |
|---|---------|---|
| T | Tapered | T |
|---|---------|---|

8. LAG EXTENSION ("T")

| | | |
|-----|--------------------|----|
| XXX | 35 mm up to 250 mm | 50 |
|-----|--------------------|----|

2. FLANGE MATERIAL

| | | | | |
|----|--------------------------|----|--------------|----|
| MB | Carbon Steel / ASTM A105 | MG | AISI 316L SS | MB |
| MC | AISI 304 SS | MV | Titanium | |
| MF | AISI 316 SS | | | |
| MM | Monel | | | |
| MO | Hastelloy C-276 | | | |
| MR | Inconel 625 | | | |
| MI | AISI 321 SS | | | |

9. CONNECTION LENGTH ("H")

| | | |
|-----|--------------------------------|----|
| XXX | Mention in 'mm' (minimum 30mm) | 30 |
|-----|--------------------------------|----|

10. ROOT DIAMETER ("D")

| | | |
|------|-----------------|----|
| XX.X | Mention in 'mm' | 25 |
|------|-----------------|----|

3. WELL MATERIAL

| | | | | |
|----|--------------------------|----|--------------|----|
| MB | Carbon Steel / ASTM A105 | MG | AISI 316L SS | MB |
| MC | AISI 304SS | MV | Titanium | |
| MF | AISI 316 SS | | | |
| MM | Monel | | | |
| MO | Hastelloy C-276 | | | |
| MR | Inconel 625 | | | |
| MI | AISI 321 SS | | | |

11. TIP DIAMETER ("G")

| | | |
|------|-----------------|----|
| XX.X | Mention in 'mm' | 18 |
|------|-----------------|----|

12. BORE DIAMETER ("d")

| | | | | |
|----|--------------|----|--------|----|
| NN | 6.35 mm (¼") | VV | 9.0 mm | |
| UU | 7.0 mm | OO | 10 mm | UU |
| WW | 9.6 mm | ZZ | 13 mm | |
| YY | 11 mm | | | |

4. INSTRUMENT CONNECTION

| | | | | |
|-----|------------------|-----|------------|-----|
| 02N | ¼" NPT (F) | 04N | ½" NPT (F) | 02N |
| 05N | ¾" NPT (F) | 02B | ¼" BSP (F) | |
| 04B | ½" BSP (F) | 05B | ¾" BSP (F) | |
| 04M | M20 x 1.5 mm (F) | | | |

13. IMMERSION LENGTH ("U")

| | | |
|------|---------------------|-----|
| XXXX | 50 mm up to 1000 mm | 150 |
|------|---------------------|-----|

5. PROCESS CONNECTION

| | | |
|-----|----------------------------------|-----|
| XXX | Refer Flange Table for the codes | XXX |
|-----|----------------------------------|-----|

14. TIP THICKNESS ("t")

| | | |
|----|--------------|----|
| QQ | 5 mm | QQ |
| NN | 6.35 mm (¼") | |
| RR | 8 mm | |
| OO | 10 mm | |

6. FLANGE FACING

| | | |
|----|-----------------|----|
| FF | Flat Face | FF |
| RJ | Ring-Type Joint | |
| RF | Raised Face | |

15. CONSTRUCTION

| | | |
|----|--|----|
| FA | Flange & well full penetration welded | FA |
| FB | Flange & well thread jointed and seal Welded | |
| FC | Flange & well seal welded | |

7. HEAD SIZE

| | | |
|----|-----------------|----|
| XX | Mention in 'mm' | 30 |
|----|-----------------|----|

Recommended :

30 mm for flanges up to 1.5" sizes

35 mm for flanges above 1.5" sizes

16. COATING ON WELL & FLANGE

| | | |
|----|------|----|
| ME | PTFE | ME |
|----|------|----|

NOTES

- Other diameters, connections are available, please contact factory for details.
- Please refer "Technical Reference" for the proper selection of connections according to Head size and Outer diameter of the well.

ORDERING CODES

17. OTHER OPTIONS

| | | |
|-----------|--------------------------------|-----------|
| XI | Plug & chain in SS | |
| XK | Electro polishing | |
| XL | Marking by laser | |
| XM | Marking by engraving | XM |
| XN | Collar type (According to WFC) | |
| TC | Material test certificate | |
| TD | Dye penetration test | |
| TF | PMI test | |
| TH | Hydro test certificate | |
| TN | NACE standards | |
| TW | WFC as per PTC 19.3TW:2010 | |

Ordering Example : W101-T-MB-MB-02N-XXX-FF-30-50-30-25-18-UU-150-QQ-FA-ME-XM

Flange Table

ANSI B 16.5

| Code | Size | Rating | Code | Size | Rating | Code | Size | Rating |
|------|------|--------|------|------|--------|------|------|--------|
| A01 | ½" | 150# | A02 | ½" | 300# | A03 | ½" | 600# |
| A04 | ½" | 900# | A05 | ½" | 1500# | A06 | ½" | 2500# |
| A07 | ¾" | 150# | A08 | ¾" | 300# | A09 | ¾" | 600# |
| A10 | ¾" | 900# | A11 | ¾" | 1500# | A12 | ¾" | 2500# |
| A13 | 1" | 150# | A14 | 1" | 300# | A15 | 1" | 600# |
| A16 | 1" | 900# | A17 | 1" | 1500# | A18 | 1" | 2500# |
| A19 | 1¼" | 150# | A20 | 1¼" | 300# | A21 | 1¼" | 600# |
| A22 | 1¼" | 900# | A23 | 1¼" | 1500# | A24 | 1¼" | 2500# |
| A25 | 1½" | 150# | A26 | 1½" | 300# | A27 | 1½" | 600# |
| A28 | 1½" | 900# | A29 | 1½" | 1500# | A30 | 1½" | 2500# |
| A31 | 2" | 150# | A32 | 2" | 300# | A33 | 2" | 600# |
| A34 | 2" | 900# | A35 | 2" | 1500# | A36 | 2" | 2500# |
| A37 | 2½" | 150# | A38 | 2½" | 300# | A39 | 2½" | 600# |
| A40 | 2½" | 900# | A41 | 2½" | 1500# | A42 | 2½" | 2500# |
| A43 | 3" | 150# | A44 | 3" | 300# | A45 | 3" | 600# |
| A46 | 3" | 900# | A47 | 3" | 1500# | A48 | 3" | 2500# |
| A49 | 4" | 150# | A50 | 4" | 300# | A51 | 4" | 600# |
| A52 | 4" | 900# | A53 | 4" | 1500# | A54 | 4" | 2500# |

NOTES

1. Other diameters, connections are available, please contact factory for details.
2. Please refer "Technical Reference" for the proper selection of connections according to Head size and Outer diameter of the well.

03/03